



AIRCHARGER™

HIGH-FLOW INTAKE KITS

LEGAL IN CALIFORNIA ONLY FOR RACING VEHICLES
WHICH MAY NEVER BE USED, REGISTERED
OR LICENSED FOR USE UPON A HIGHWAY.

See knfilters.com for CARB status on each part for a specific vehicle

INSTALLATION INSTRUCTIONS

63-9028 TOYOTA 2005-06 TUNDRA V6 4.0L

NOTE: This kit was not designed to fit vehicles with a body lift.

TOOLS NEEDED:

Ratchet
Extension
10mm Socket
10mm Wrench
Phillips Screwdriver
2.5mm Allen Wrench
4mm Allen Wrench
Flat Blade Screwdriver

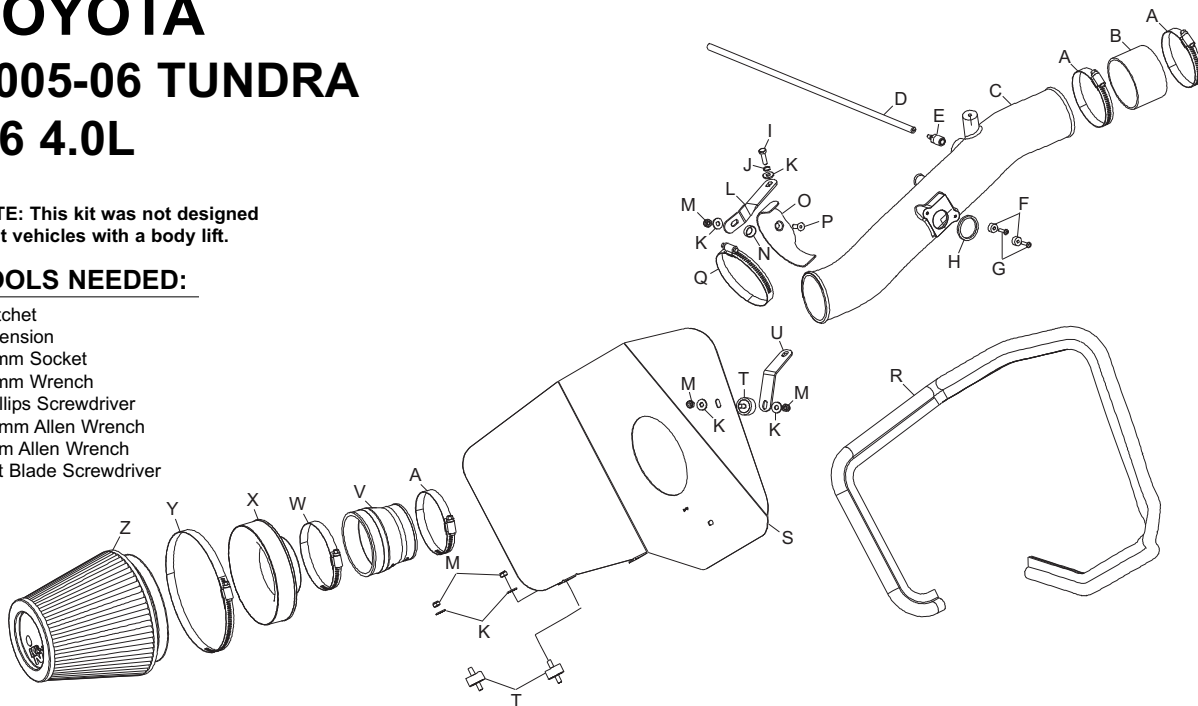

PARTS LIST:

Desc.	Qty.	Part #
A hose clamp; #48	3	08601
B hose; 3" x 2" black	1	08434
C intake tube (FK)	1	087181
D hose; 4mm x 18", silicone black	1	08153
E vent; 3/16" barb x 1/4" npt	1	080021
F screw; m4-.7 x 16mm btn head allen	2	07793
G spacer	2	06531
H gasket	1	09013
I bolt; 6mm-1.00 x 12mm, hex	1	07863
J washer; 1/4" id split lock	1	08198
K washer; 1/4" id x 5/8" od, flat	6	08275
L bracket twist	1	07945
M nut; 6mm nylock	5	07553
N cup washer	1	08180
O saddle bracket	1	078855
P bolt; 6mm-1.00 x 20mm f/h/a	1	08376
Q hose clamp; #52	1	08610
R edge trim 61"	1	102492
S heat shield	1	07454
T stud; m6-1.00 m/m, rubber mntd	3	07027
U bracket "L"	1	070581
V hose; 3.5" to 3" tapered black	1	08724
W hose clamp #56	1	08620
X adapter #380	1	21512
Y hose clamp #104	1	08697
Z filter charger	1	RF-1042

NOTE: FAILURE TO FOLLOW INSTALLATION INSTRUCTIONS AND NOT USING THE PROVIDED HARDWARE MAY DAMAGE THE INTAKE TUBE, THROTTLE BODY AND ENGINE.

TO START:

1. Turn the ignition OFF and disconnect the vehicle's negative battery cable.



2. Loosen the two nuts that secure the engine cover, and then remove the engine cover from the engine.



3. Loosen the intake tube hose clamp at the air filter assembly.

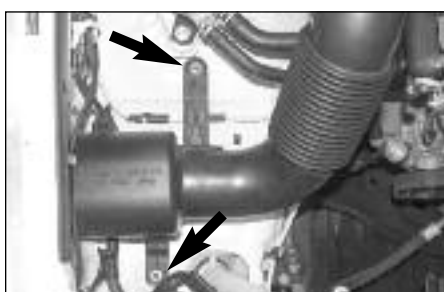

4. Remove the two bolts which secure the intake resonator to the fender well.



5. Remove the intake tube from the vehicle.



6. Disconnect the two mass air wire harness retaining clips from air box, then disconnect the mass air sensor electrical connection.



7. Remove crank case vent hose from air box as shown.



8. Remove fuel pressure regulator hose from back side of air box.

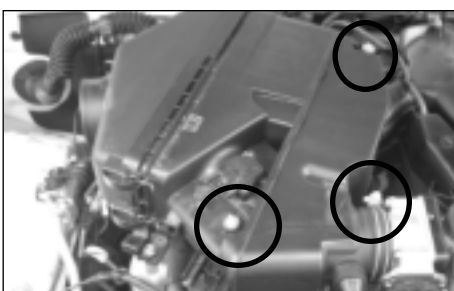

9. Loosen the hose clamp at throttle body, then remove the two bolts that secure air box to engine.



10. Remove air box assembly from engine as shown.

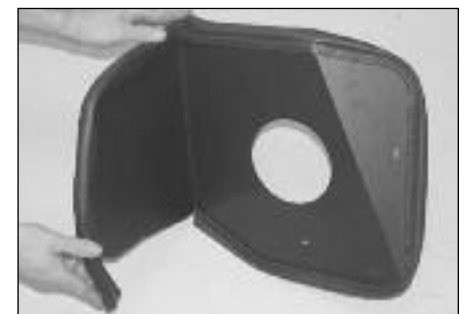

11. Install the provided edge trim onto the K&N intake tube as shown.

NOTE: Some trimming of the edge trim will be necessary.



12. Install the rubber mounted stud to the heat shield with the provided hardware, but do not tighten completely at this time.



13. Secure the mounting bracket to the rubber mounted stud with the provided hardware as shown.



14. Install the two remaining rubber mounted studs to the original air box mounting holes as shown.



15. Install the heat shield into the vehicle so that the mounting tabs rest on the rubber mounted studs installed in step #14.



16. Secure the mounting bracket to the fan shroud with the original bolt.



17. Install the silicone hose (08434) onto the throttle body and secure with the provided hose clamp as shown.



18. Remove the two screws that secure the mass air sensor to the air box assembly, then remove the mass air sensor as shown.



19. Apply the gasket to the mass air sensor, sticky side down as shown.



20. Install the provided 1/4" npt fitting into the K&N intake tube as shown.



21. Install the mass air sensor into the K&N intake tube with the spacers and bolts provided.



22. Assemble the saddle clamp onto the tube mounting bracket as shown with the provided hardware.



23. Install the tube mounting bracket onto the threaded boss on the valve cover with the provided hardware as shown.

NOTE: Do not tighten completely at this time.



24. Install the K&N intake tube into the silicone hose at the throttle body and align with the bracket installed in step #23. Secure the intake tube with the hose clamps provided.



25. Remove the factory crank case vent hose from the valve cover and then remove the factory clamp and outer cover from the crank case vent hose as shown.

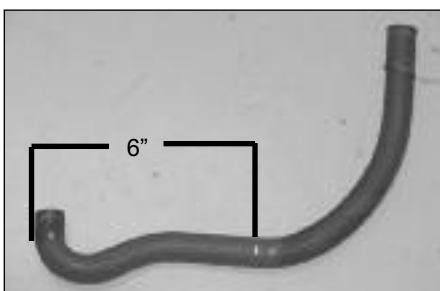

26. Measure 6" from the end of the crank case vent hose as shown and cut the hose.



27. Reinstall the crank case vent hose into the valve cover and then connect the cut end to the K&N intake tube as shown. Secure the vent hose with the factory spring clamps.



28. Remove the stock vacuum hose from the fuel pressure regulator, then install the provided silicone hose to the fuel pressure regulator and then onto the K&N intake tube as shown.



29. Install the filter adapter into the Filtercharger as shown.



30. Install the silicone hose (08724) onto the Filtercharger assembly as shown and secure with the provided hose clamp.



31. Install the Filtercharger assembly onto the K&N intake tube and secure with the provided hose clamp.



32. Using a pair of pliers, remove the engine cover mounting stud shown from the factory air box.



33. Install the engine cover mounting stud into the threaded stand off on the K&N intake tube as shown.



34. Using the provided template, mark the trim lines onto the engine cover and then cut with the appropriate tool.



35. Install the engine cover and secure with the factory mounting nuts removed in step #2.



36. Reconnect the mass air sensor electrical connection.



37. Reconnect the vehicle's negative battery cable. Double check to make sure everything is tight and properly positioned before starting the vehicle.

38. It will be necessary for all AIRCHARGER's to be checked periodically for realignment, clearance and tightening of all connections. Failure to follow the above instructions or proper maintenance may void warranty.

ROAD TESTING:

1. Start the engine with the transmission in neutral or park, and the parking brake engaged. Listen for air leaks or odd noises. For air leaks secure hoses and connections. For odd noises, find cause and repair before proceeding. This kit will function identically to the factory system except for being louder and much more responsive.

2. Test drive the vehicle. Listen for odd noises or rattles and fix as necessary.

3. If road test is fine, you can now enjoy the added power and performance from your kit.

4. K&N suggests checking the Filtercharger element periodically for excessive dirt build-up. When the element becomes covered in dirt (or once a year), service it according to the instructions on the Recharger service kit, part number 99-5050 or 99-5000.

LEGAL IN CALIFORNIA ONLY FOR RACING VEHICLES WHICH MAY NEVER BE USED, REGISTERED OR LICENSED FOR USE UPON A HIGHWAY.

See knfilters.com for CARB status on each part for a specific vehicle

Cut out along the dotted line and use templet for step #34.

