



TYPHOON INTAKE SYSTEMS

INTAKE SYSTEMS FOR VEHICLES LISTED ARE 50 STATE LEGAL. SEE KNFILTERS.COM FOR CARB STATUS ON EACH PART FOR A SPECIFIC VEHICLE.

INSTALLATION INSTRUCTIONS

69-7078TS
NISSAN / INFINITI
2009-14 370Z / 370Z NISMO
2008-13 G37
V6-3.7L

TOOLS NEEDED:

- Ratchet
- Extension
- 13mm socket
- 10mm socket
- Flat blade screw driver
- Phillips screw driver
- Pliers
- 3mm allen wrench
- 10mm wrench.

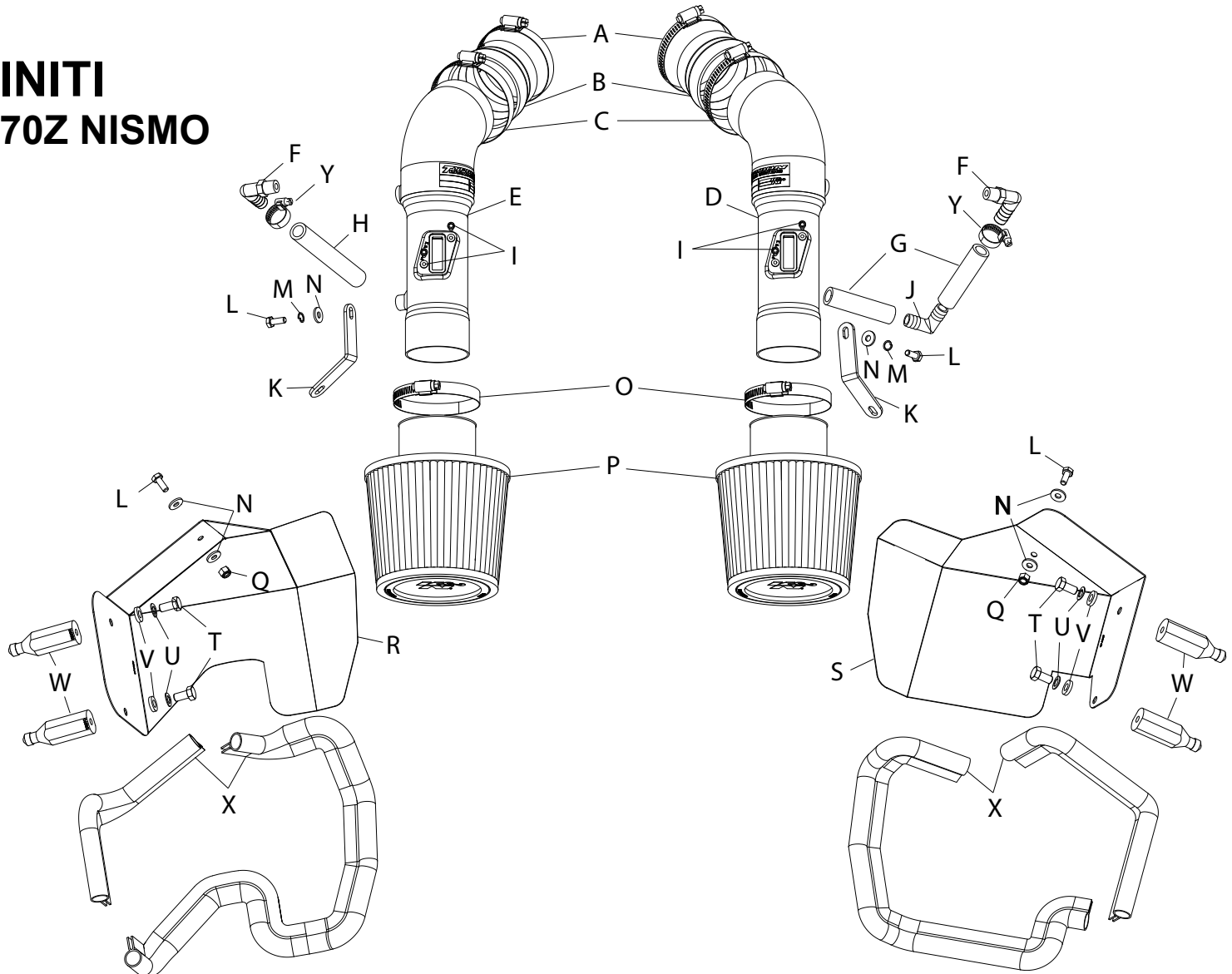

PARTS LIST:

Description	Qty.	Part #	Description	Qty.	Part #	Description	Qty.	Part #
A hose clamp #48	2	08601	J vent; 90 deg, 5/8" hose, blk	1	08072	S heat shield	1	074057
B hose; 3" to 2-3/4" id x 2' l tprd	2	084036	K bracket; angled	2	070581	T bolt; 8mm-1.25X16mm, hexhead	4	07844
C hose clamp #44 stainless	2	08560	L bolt; 6mm-1.00X16mm, ss	4	07812	U washer; 8mm spring (wave)	4	08239
D intake tube	1	27466	M washer; 1/4" lock, zn	2	08198	V washer; 5/16" id x 5/8" od, flat	4	08276
E intake tube	1	27467	N washer; 1/4" id x 5/8" od	6	08275	W standoff	4	06532
F vent; 90deg, 1/2" hose, 1/4" npt,	2	08110	O hose clamp #44	2	08577	X edge trim (39")	2	102496
G hose; 5/8" id x 4' l	2	08485	P air filter	2	RU-4960XD	Y hose clamp	2	08410
H hose; 5/8" id x 7' l	1	08159	Q nut; 6mm nylock, hexhead,	2	07512			
I bolt; m4-0.07 8Mm, a/h cap	4	07733	R heat shield	1	074058			

If you need any assistance please call 1-800-858-3333 to speak with a representative in our Customer Service Center before returning the product.

NOTE: FAILURE TO FOLLOW INSTALLATION INSTRUCTIONS AND NOT USING THE PROVIDED HARDWARE MAY DAMAGE THE INTAKE TUBE, THROTTLE BODY AND ENGINE.

TO START:

1. Turn off the ignition and disconnect the negative battery cable.
NOTE: Disconnecting the negative battery cable erases pre-programmed electronic memories. Write down all memory settings before disconnecting the negative battery cable. Some radios will require an anti-theft code to be entered after the battery is reconnected. The anti-theft code is typically supplied with your owner's manual. In the event your vehicles' anti-theft code cannot be recovered, contact an authorized dealership to obtain your vehicles anti-theft code.



2. Remove the two bolts which secure the front engine cover and then remove the front engine cover.
NOTE: On models not equipped with a strut tower brace it will be necessary to remove all five bolts securing the engine cover.



3. Disconnect the passenger side mass air sensor and unhook the wiring harness from the air box.



4. Loosen the hose clamp which secures the passenger side intake hose to the air box. Remove the bolt which secures the air box to the inner fender.



5. Remove the passenger side air box from the vehicle.



6. Remove the bolt shown which secures the crank case vent tube assembly to the intake plenum.



7. Loosen the hose clamp that secures the right side intake tube to the throttle body.



8. Remove the right side intake hose from the vehicle.

NOTE: It will be necessary to release the spring clamp which secures the crank case vent hose to the valve cover port and then disconnect the crank case vent hose from the valve cover.



9. Disconnect the Driver's side mass air sensor and unhook the wiring harness from the air box.



10. Loosen the hose clamp which secures the right side intake hose to the air box. Remove the bolt which secures the air box to the inner fender.



11. Remove the driver's side air box from the vehicle.



12. Loosen the hose clamp that secures the driver's side intake tube to the throttle body.



13. Remove the left side intake hose from the vehicle.

NOTE: It will be necessary to release the spring clamp which secures the crank case vent hose to the valve cover port and then disconnect the crank case vent hose from the valve cover.
NOTE: K&N Engineering, Inc., also recommends that customers do not discard factory air intake.



14. Install the silicone hose (084036) onto the driver's side throttle body and secure with the provided hose clamp.



15. Install the two heat shield mounting pins onto the driver's side heat shield (074057) and secure with the provided hardware.

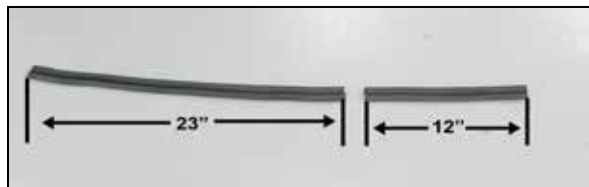

16. Cut the provided edge trim into two sections as shown, one section will be 12" long and the other section should be 23" long as shown.

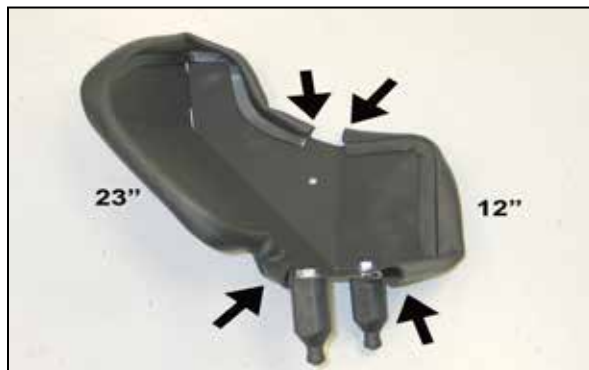

17. Install the trimmed edge trim onto the heat shield as shown.

NOTE: Be sure to leave a gap for the tube mounting bracket as shown.



18. Install the heat shield assembly into the vehicle so that the mounting pins engage into the air box mounting grommets.



19. Install the provided 90° npt vent fitting into the driver's side K&N® intake tube (27466) as shown.
NOTE: Plastic NPT fittings are easy to cross thread. Install the vent fitting "hand" tight, then turn it two complete turns with a wrench.



20. Remove the two screws securing the mass air sensor to the driver's side air box and then remove the mass air sensor from the air box.



21. Install the mass air sensor into the driver's side K&N® intake tube and secure with the provided hardware.



22. Install the tube mounting bracket onto the driver's side K&N® intake tube as shown and secure with the provided hardware.

NOTE: The part number of the bracket will be on the leg pointing down away from the intake tube when installed properly.



23. Install the K&N® intake tube into the silicone hose at the throttle body and align the bracket with the mounting hole in the heat shield. Adjust the tube and heat shield for proper fit and then secure with the provided hardware and hose clamp.
NOTE: The tube mounting bracket is to be attached on the back side of the heat shield.



24. Connect the two 3" pieces of crank case vent hose to the 90° vent fitting as shown.



25. Connect one end of the crank case vent hose to the 90° vent fitting on the driver's side K&N® intake tube and then connect the other end to the vent port on the valve cover. Secure the hose to the fitting on the tube with the provided hose clamp.



26. Install the K&N® air filter onto the K&N® intake tube and secure with the provided hose clamp.
NOTE: Drycharger® air filter wrap; part # RX-4990DK is available to purchase separately. To learn more about Drycharger® filter wraps or look up color availability please visit <http://www.knfilters.com>.



27. Reconnect the mass air sensor electrical connection.



28. Install the silicone hose (084036) onto the passenger side throttle body and secure with the provided hose clamp.



29. Install the two heat shield mounting pins onto the passenger side heat shield (074058) and secure with the provided hardware.

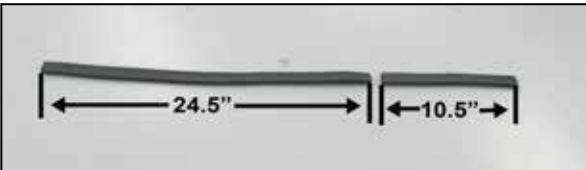

30. Cut the provided edge trim into two sections as shown. 10.5" & 24.5"

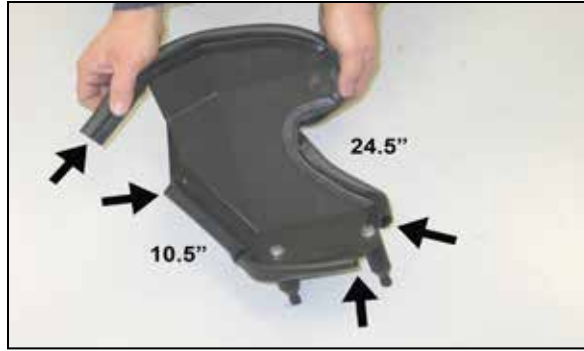

31. Install the provided edge trim onto the heat shield as shown.

NOTE: Be sure to leave a gap for the tube mounting bracket as shown.



32. Install the heat shield assembly into the vehicle so that the mounting pins engage into the air box mounting grommets.



33. Install the provided 90° npt vent fitting into the K&N® intake tube (27467) as shown.

NOTE: Plastic NPT fittings are easy to cross thread. Install the vent fitting "hand" tight, then turn it two complete turns with a wrench.



34. Remove the two screws securing the mass air sensor to the air box and then remove the mass air sensor from the air box.



35. Install the mass air sensor into the passenger side K&N® intake tube and secure with the provided hardware.



36. Install the tube mounting bracket onto the passenger side K&N® intake tube as shown and secure with the provided hardware.
NOTE: The part number of the bracket will be on the leg pointing down from the intake tube when installed properly.



37. Install the K&N® intake tube into the silicone hose at the throttle body and align the bracket with the mounting hole in the heat shield. Adjust the tube and heat shield for proper fit and then secure with the provided hardware and hose clamp.

NOTE: The tube mounting bracket is to be attached on the back side of the heat shield.



38. Install the 7" crank case vent hose onto the 90° fitting on the K&N® intake tube and then attach the open end to the vent port on the valve cover. Secure the hose to the fitting on the tube with the provided hose clamp.



39. Install the K&N® air filter onto the K&N® intake tube and secure with the provided hose clamp.
NOTE: Drycharger® air filter wrap; part # RX-4990DK is available to purchase separately. To learn more about Drycharger® filter wraps or look up color availability please visit <http://www.knfilters.com>.



40. Reconnect the mass air sensor electrical connection.



41. Adjust the intake tubes for uniform fit and then reinstall the engine cover and secure with the factory bolts.



42. Reconnect the vehicle's negative battery cable. Double check to make sure everything is tight and properly positioned before starting the vehicle.

43. The C.A.R.B. exemption sticker, (attached), must be visible under the hood so that an emissions inspector can see it when the vehicle is required to be tested for emissions. California requires testing every two years, other states may vary.

44. It will be necessary for all K&N® high flow intake systems to be checked periodically for realignment, clearance and tightening of all connections. Failure to follow the above instructions or proper maintenance may void warranty.

ROAD TESTING:

1. Start the engine with the transmission in neutral or park, and the parking brake engaged. Listen for air leaks or odd noises. For air leaks secure hoses and connections. For odd noises, find cause and repair before proceeding. This kit will function identically to the factory system except for being louder and much more responsive.

2. Test drive the vehicle. Listen for odd noises or rattles and fix as necessary.

3. If road test is fine, you can now enjoy the added power and performance from your kit.

4. K&N Engineering, Inc., suggests checking the air filter element periodically for excessive dirt build-up. When the element becomes covered in dirt (or once a year), service it according to the instructions on the Recharger® service kit, part number 99-5050 or 99-5000

INTAKE SYSTEMS FOR VEHICLES LISTED ARE 50 STATE LEGAL. SEE KNFILTERS.COM FOR CARB STATUS ON EACH PART FOR A SPECIFIC VEHICLE.