



NOT LEGAL FOR SALE OR USE ON ANY POLLUTION CONTROLLED MOTOR VEHICLE IN CALIFORNIA OR STATES ADOPTING CALIFORNIA EMISSION PROCEDURES.
See knfilters.com for CARB status on each part for a specific vehicle

INSTALLATION INSTRUCTIONS

71-7078

NISSAN / INFINITI

2009-19 370Z / 370Z NISMO

2008-13 G37

TOOLS NEEDED:

flat blade screw driver
phillips screw driver
ratchet
extension
13mm socket
10mm socket
3mm allen wrench
10mm wrench
pliers

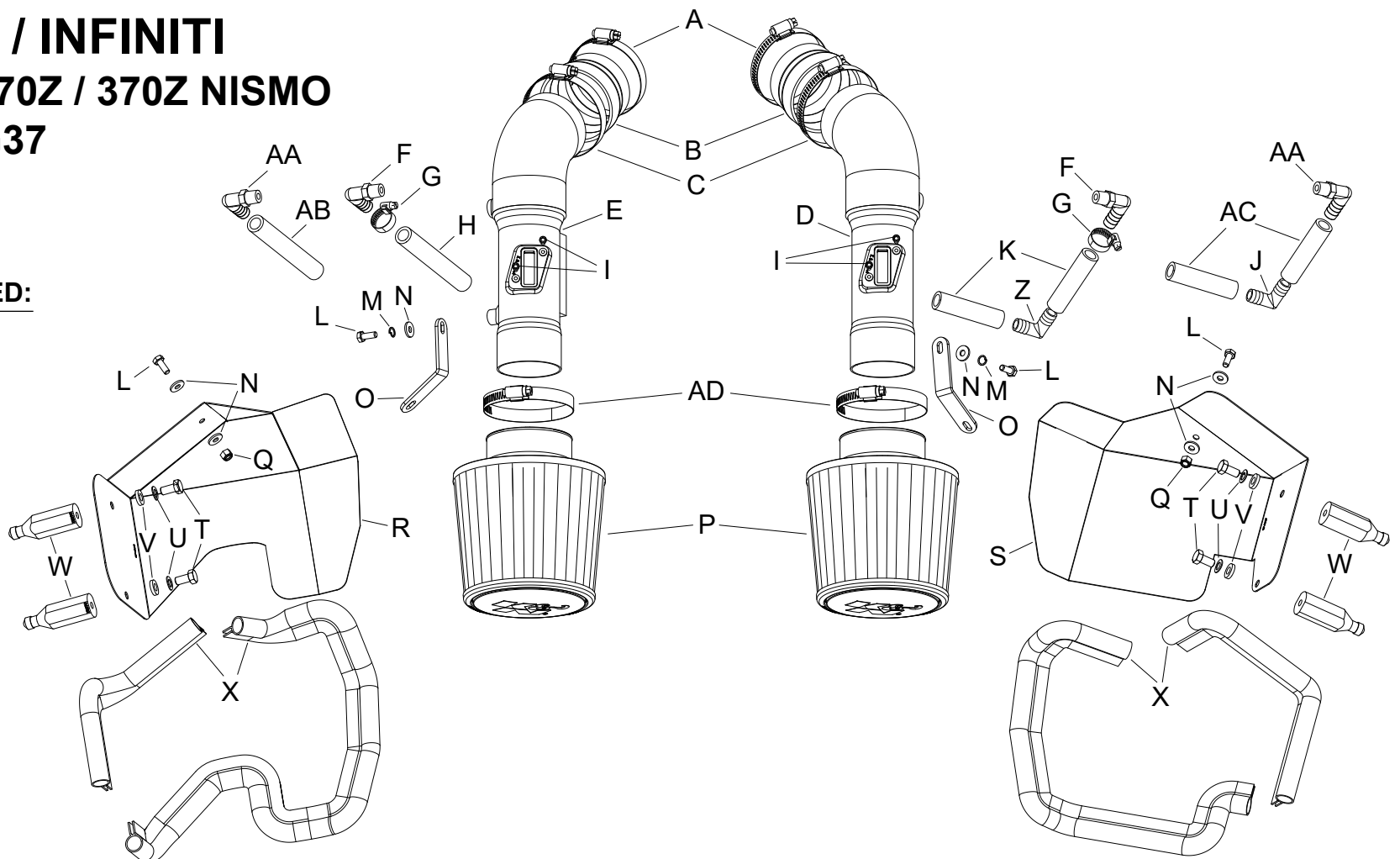

PARTS LIST:

Description	Qty.	Part #	Description	Qty.	Part #	Description	Qty.	Part #
A HOSE CLAMP #48	2	08601K	J VENT; 90 DEG, 5/8"HOSE, BLK	1	08072	T BOLT; 8MM-1.25 X 16MM	4	07844
B HOSE; 3" TO 2-3/4" ID X 2" L	2	084036	K HOSE; 1/2"ID X 3"L	2	5-5003	U WASHER; 8MM SPRING	4	08239
C HOSE CLAMP; #44, BLACK	2	08560K	L BOLT; 6MM-1.00 X 16MM, SS	4	07812	V WASHER; 5/16"ID X 5/8"OD	4	08276
D INTAKE TUBE	1	27466TK	M WASHER; 1/4" LOCK, ZN	2	08198	W STANDOFF; 6.0 FORD AIRBOX	4	06532
E INTAKE TUBE	1	27642TK	N WASHER; 1/4"ID X 5/8"OD	6	08275	X EDGE TRIM (39")	2	102496
F VENT; 90DEG, 1/2"HOSE,1/4"	2	08110FK	O BRACKET; 57-9014, ANGLED	2	070581	Z 90 DEGREE 1/2" MENDER	1	08065
G HOSE CLAMP #8 MINI	2	08410	P AIR FILTER	2	RU-3103HBK	AA 90 DEGREE 5/8" NPT	2	08525
H HOSE; 1/2"ID X 5"L	1	5-5007	Q NUT; 6MM NYLOCK, HEXHEAD	2	07512	AB HOSE: 5/8"X7"L	1	084008
I BOLT; M4 - 0.07 8MM, A/H CAP	4	07733	R HEAT SHIELD	1	074058	AC HOSE: 5/8"X4"L	2	08244
			S HEAT SHIELD	1	074057	AD HOSE CLAMP #44	2	08577

If you need any assistance please call 1-800-858-3333 to speak with a representative in our Customer Service Center before returning the product.

NOTE: FAILURE TO FOLLOW INSTALLATION INSTRUCTIONS AND NOT USING THE PROVIDED HARDWARE MAY DAMAGE THE INTAKE TUBE, THROTTLE BODY AND ENGINE.

TO START:

1. Turn off the ignition and disconnect the negative battery cable.

NOTE: Disconnecting the negative battery cable erases pre-programmed electronic memories. Write down all memory settings before disconnecting the negative battery cable. Some radios will require an anti-theft code to be entered after the battery is reconnected. The anti-theft code is typically supplied with your owner's manual. In the event your vehicles anti-theft code cannot be recovered, contact an authorized dealership to obtain your vehicles anti-theft code.

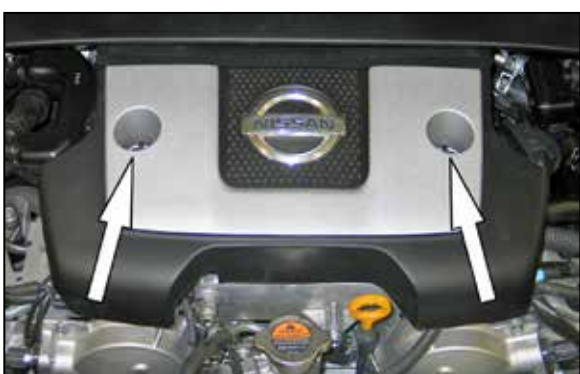

2. Remove the two bolts which secure the front engine cover and then remove the front engine cover.



3. Disconnect the passenger side mass air sensor and unhook the wiring harness from the air box.



4. Loosen the hose clamp which secures the passenger side intake hose to the air box. Remove the bolt which secures the air box to the inner fender.



5. Remove the passenger side air box from the vehicle.

NOTE: K&N Engineering, Inc., recommends that customers do not discard factory air intake.



6. Remove the bolt shown which secures the crank case vent tube assembly to the intake plenum.



7. Loosen the hose clamp that secures the right side intake tube to the throttle body.



8. Remove the right side intake hose from the vehicle.

NOTE: It will be necessary to release the spring clamp which secures the crank case vent hose to the valve cover port and then disconnect the crank case vent hose from the valve cover.



9. Disconnect the Driver's side mass air sensor and unhook the wiring harness from the air box.



10. Loosen the hose clamp which secures the right side intake hose to the air box. Remove the bolt which secures the air box to the inner fender.



11. Remove the driver's side air box from the vehicle.



12. Loosen the hose clamp that secures the driver's side intake tube to the throttle body.



13. Remove the driver's side intake hose from the vehicle.

NOTE: It will be necessary to release the spring clamp which secures the crank case vent hose to the valve cover port and then disconnect the crank case vent hose from the valve cover.



14. Install the coupling hose (084036) onto the driver's side throttle body and secure with the provided hose clamp.



15. Install the two heat shield mounting pins onto the driver's side heat shield (074057) and secure with the provided hardware.

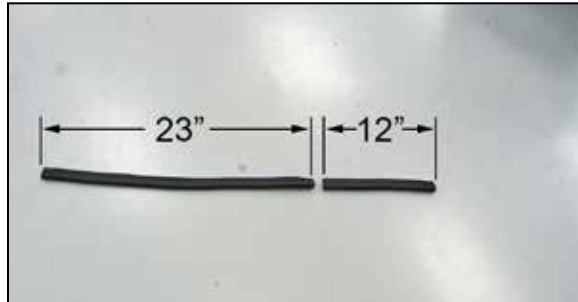

16. Cut the provided edge trim into two sections as shown, one section will be 12" long and the other section should be 23" long as shown.

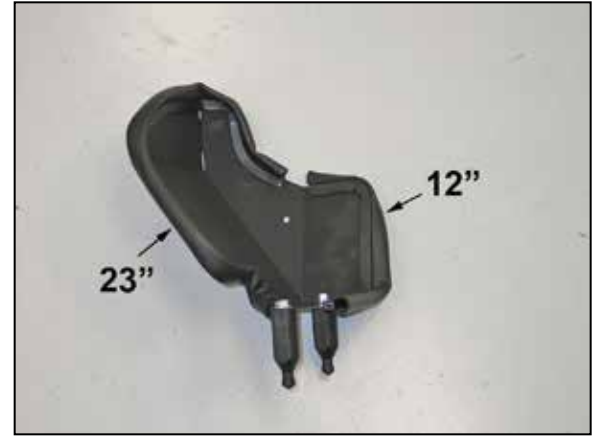

17. Install the trimmed edge trim onto the heat shield as shown.

NOTE: Be sure to leave a gap for the tube mounting bracket as shown.



18. Install the heat shield assembly into the vehicle so that the mounting pins engage into the air box mounting grommets.



19. Install the provided 90° NPT vent fitting into the driver's side K&N® intake tube (27466) as shown.

NOTE: Plastic NPT fittings are easy to cross thread. Install the vent fitting "hand" tight, then turn it two complete turns with a wrench.



20. Remove the two screws securing the mass air sensor to the driver's side air box and then remove the mass air sensor from the air box.



21. Install the mass air sensor into the driver's side K&N® intake tube and secure with the provided hardware.



22. Install the tube mounting bracket onto the driver's side K&N® intake tube as shown and secure with the provided hardware.

NOTE: The part number of the bracket will be on the leg pointing down away from the intake tube when installed properly.



23. Install the K&N® intake tube into the silicone hose at the throttle body and align the bracket with the mounting hole in the heat shield. Adjust the tube and heat shield for proper fit and then secure with the provided hardware and hose clamp.

NOTE: The tube mounting bracket is to be attached on the back side of the heat shield.



24. Connect the two 3" pieces of crank case vent hose and hose clamp to the 90° vent fitting as shown.

NOTE: Choose the appropriate size hose and fitting for your application. Some models vary between 1/2" and 5/8".



25. Connect the end of the crank case vent hose with the hose clamp to the 90° vent fitting on the driver's side K&N® intake tube and then connect the other end to the vent port on the valve cover.
NOTE: Some trimming of the crank case vent hose may be necessary.



26. Install the K&N® air filter onto the K&N® intake tube and secure with the provided hose clamp.



27. Reconnect the mass air sensor electrical connection.



28. Install the coupling hose (084036) onto the passenger side throttle body and secure with the provided hose clamp.



29. Install the two heat shield mounting pins onto the passenger side heat shield (074058) and secure with the provided hardware.

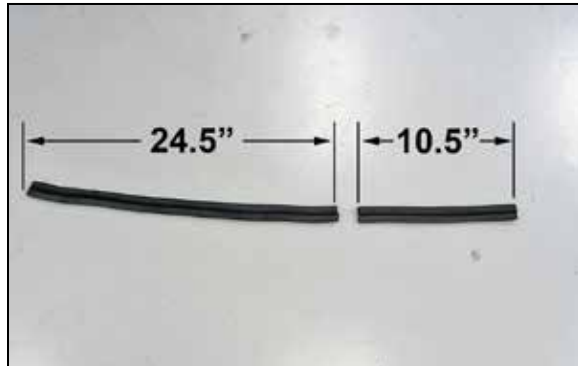

30. Cut the provided edge trim into two sections as shown. 10.5" & 24.5"



31. Install the provided edge trim onto the heat shield as shown.

NOTE: Be sure to leave a gap for the tube mounting bracket as shown.



32. Install the heat shield assembly into the vehicle so that the mounting pins engage into the air box mounting grommets.

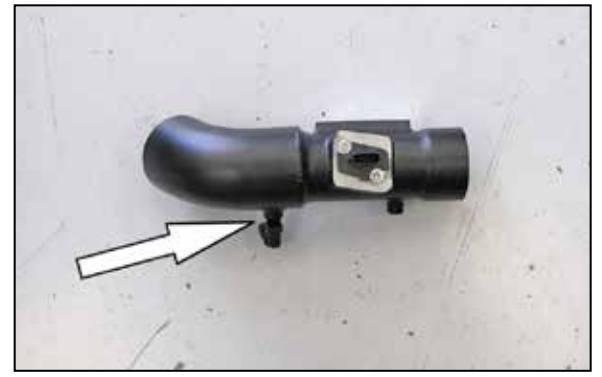

33. Install the provided 90° NPT vent fitting into the K&N® intake tube (27642) as shown.

NOTE: Plastic NPT fittings are easy to cross thread. Install the vent fitting "hand" tight, then turn it two complete turns with a wrench.



34. Remove the two screws securing the mass air sensor to the air box and then remove the mass air sensor from the air box.



35. Install the mass air sensor into the passenger side K&N® intake tube and secure with the provided hardware.

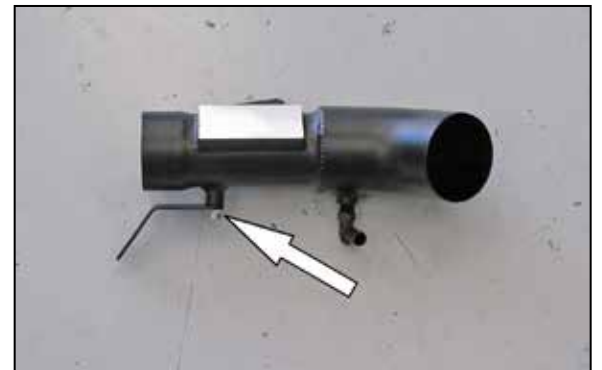

36. Install the tube mounting bracket onto the passenger side K&N® intake tube as shown and secure with the provided hardware.

NOTE: The part number of the bracket will be on the leg pointing down from the intake tube when installed properly.



37. Install the K&N® intake tube into the coupling hose at the throttle body and align the bracket with the mounting hole in the heat shield. Adjust the tube and heat shield for proper fit and then secure with the provided hardware and hose clamp.
NOTE: The tube mounting bracket is to be attached on the back side of the heat shield.



38. Install the 5" crank case vent hose onto the 90° fitting on the K&N® intake tube and then attach the open end to the vent port on the valve cover.

NOTE: Choose the appropriate size hose and fitting for your application. Some models vary between 1/2" and 5/8".



39. Install the air filter onto the intake tube and secure with the provided hose clamp.



40. Reconnect the mass air sensor electrical connection.



41. Adjust the intake tubes for uniform fit and then reinstall the engine cover and secure with the factory bolts.



42. Reconnect the vehicle's negative battery cable. Double check to make sure everything is tight and properly positioned before starting the vehicle.

43. It will be necessary for all K&N® high flow intake systems to be checked periodically for realignment, clearance and tightening of all connections. Failure to follow the above instructions or proper maintenance may void warranty.

ROAD TESTING:

1. Start the engine with the transmission in neutral or park, and the parking brake engaged. Listen for air leaks or odd noises. For air leaks secure hoses and connections. For odd noises, find cause and repair before proceeding. This kit will function identically to the factory system except for being louder and much more responsive.

2. Test drive the vehicle. Listen for odd noises or rattles and fix as necessary.

3. If road test is fine, you can now enjoy the added power and performance from your kit.

4. K&N Engineering, Inc., requires cleaning the Blackhawk Induction™ intake system's air filter element every 100,000 miles. When used in dusty or off-road environments, our filters will require cleaning more often. We recommend that you visually inspect your filter once every 25,000 miles to determine if the screen is still visible. When the screen is no longer visible some place on the filter element, it is time to clean it. To clean, purchase our Synthetic Filter Cleaner, part number 99-0624 and follow the easy instructions.

NOT LEGAL FOR SALE OR USE ON ANY POLLUTION CONTROLLED MOTOR VEHICLE IN CALIFORNIA OR STATES ADOPTING CALIFORNIA EMISSION PROCEDURES.

See knfilters.com for CARB status on each part for a specific vehicle